

FLEXIBLE CONDUITS

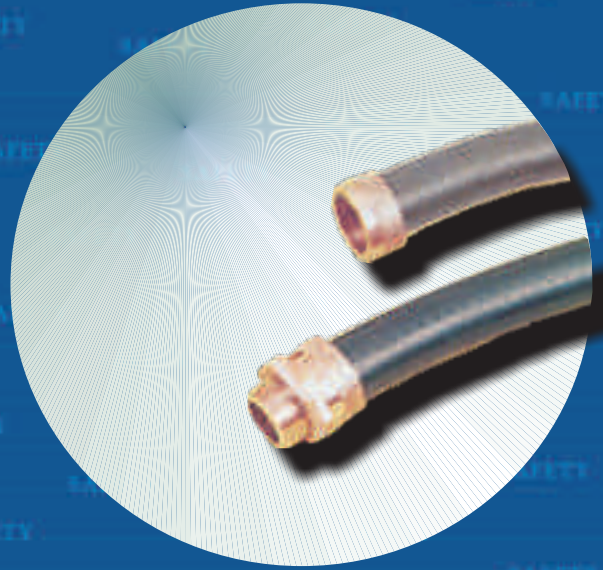

Marching towards safer future



BMC Type Flexible Conduits



Standard industrial conduit with galvanised sheet steel inner core and pvc oversheath.

A single clutch application on the steel inner core allows good crush protection and high flexibility.

Part No.. BLACK	ID X OD mm	Standard mt coil	Trade Size mm
BMC10	7 x 10	30	-
BMC12	10 x 14	30	12
BMC16	13 x 17	30	16
BMC19	15 x 19	30	-
BMC20	17 x 21	30	20
BMC25	21 x 27	30	25
BMC32	28 x 33	30	32
BMC40	40 x 46	25	40
BMC50	52 x 59	25	50

Also available in Grey-Add Suffix 'G'

Standard Colour	Black	
Construction	Internal single metal clutch manufactured from galvanised sheet metal with thin walled PVC oversheath.	
Temperature Rating	- 15 ° C to +80 ° C intermittent to 90 ° C.	
Protection Rating IEC 529, IP 55	LIQUID	Protect against water jets. Water projected by a nozzle against the conduit from any direction will have no harmful effect.
	DUST	Dust protected. Ingress of dust is not totally prevented, but dust does not enter in sufficient quantity to interface with the satisfactory operation of the equipment.
Flammability	To CEI 23-14V -1971 with 10 second flame resistance.	
Equivalent Standard	Meets with the requirements of BS EN 50086-2-3 and BS 731 Part 1.	
Resistance Definition	BS EN50086-1 compression force. Class 4. Heavy. UP to 2400 Newtons.	
Mechanical Tensile Strength	BS EN50086 - 1 tensile force. Class 4. Heavy. UP to 1500 Newtons	
Flexibility Grade	Excellent.	
EN 50086 Definition	Flexible conduit.	

BMC 1 Type Flexible Conduits



A high crush resistant conduit specified and used for machine tool applications, with square lock metallic clutch and an oversheath of deep vacuumed pvc coating, designed to accept brass fittings, the complete assembly ensures a high ip rating.

Part No.. BLACK	ID X OD mm	Standard mt coil	Trade Size mm
BMC112	10.00 x 15.40	30	12
BMC116	12.30 x 18.00	30	16
BMC120	15.80 x 21.30	30	20
BMC125	20.83 x 26.70	20	25
BMC132	26.44 x 33.40	20	32
BMC140	35.05 x 42.20	15	40
BMC150	40.01 x 48.30	15	50
BMC163	51.31 x 60.30	10	63

Also available in Grey-Add Suffix 'G'

Standard Colour	Black	
Construction	Internal square lock metallic clutch manufactured from galvanised sheet steel with thin walled PVC oversheath.	
Temperature Rating	-15 °C to + 80 °C intermittent to 90 °C.	
Protection Rating IEC 529, IP 55	LIQUID	Protect against water jets. Water projected by a nozzle against the conduit from any direction will have no harmful effect.
	DUST	No ingress of dust when assembled with B-Flex 100 fittings.
Flammability	To CEI 23-14V-1971 with 10 second flame resistance.	
Equivalent Standard	Meets with the requirements of BS EN 50086-2-3 and BS 731 Part 1.	
Resistance Definition	BS EN50086-1 compression force. Class5. Very Heavy Over 3000 Newtons.	
Mechanical Tensile Strength	Bs EN50086-1 tensile force. Class 4. Heavy Up to 1500 Newtons.	
Flexibility Grade	Good	
EN 50086 Definition	Flexible conduit.	

BMC 2 Type Flexible Conduits



A liquid tight conduit system with smooth outer pvc sheath allowing complete sealing of fittings to conduit.

Excellent resistance to sudden temperature variations and has a high crush resistance grading.

Part No.. BLACK	ID X OD mm	Standard mt coil	Trade Size mm
BMC212	10.0 x 14.7	30	12
BMC216	12.0 x 18.0	30	16
BMC220	15.5 x 21.0	30	20
BMC225	20.5 x 26.5	30	25
BMC232	26.5 x 33.0	30	32
BMC240	34.5 x 42.0	15	40
BMC250	39.5 x 48.0	15	50
BMC263	50.5 x 60.0	15	63

Also available in Grey-Add Suffix 'G'

Standard Colour	Black	
Construction	Internal double lock metallic clutch manufactured from galvanised sheet steel. External PVC oversheath with a smooth outer diameter.	
Temperature Rating	- 30°C to +90 °C intermittent to 95°C.	
Protection Rating IEC 529, IP 55	LIQUID	Protected against the effect of immersion. Ingress of water in harmful quantities shall not be possible when the conduit is immersed in water.
	DUST	No ingress of dust when assembled with B-Flex 100 fittings.
Flammability	To CEI 23-8/111-1973 with 10 second flame resistance.	
Equivalent Standard	Meets with the requirements of BS EN50086-2-3 and BS 731 Part 1.	
Resistance Definition	BS EN50086-1 compression force. Class5. Very Heavy Over 3000 Newtons.	
Mechanical Tensile Strength	BS EN50086-1 tensile force. Class 4. Heavy Up to 1700 Newtons.	
Flexibility Grade	Good	
EN 50086 Definition	Flexible conduit.	

Galvanised & Stainless Steel Bare Metal Conduits



Two types of Bare Metal Conduit widely used for Lighting Applications, Under floor Heating and Projects requiring High Temperature specification.

Part No.. BLACK	ID X OD mm	Standard mt coil	Trade Size mm
BGS12	10.00 x 13.00	30	12
BGS16	12.00 x 15.00	30	16
BGS18	15.00 x 18.00	30	-
BGS20	17.00 x 21.00	30	20
BGS25	21.00 x 24.60	30	25
BGS32	28.00 x 30.10	30	32
BGS40	40.00 x 45.00	30	40
BGS50	52.00 x 58.00	25	50
<i>Also available in Stainless Steel - Add Suffix 'S'</i>			

Standard Colour	BGS	
Construction	Galvanised single clutch steel conduit.	
Temperature Rating	0°C to + 300 °C.	
Protection Rating IEC 529, IP 40	LIQUID	No Protection.
	DUST	Protection against objects of thickness greater than 1 mm. Protection against the ingress of small foreign bodies.
Flammability	Low fire hazard.	
Equivalent Standard	Meets with the requirements of BS EN 50086-2-3 and BS 731.	
Resistance Definition	BS EN50086-1 compression force. Class 4. Heavy Over 2400 Newtons.	
Mechanical Tensile Strength	BS EN50086-1 tensile force. Class 4. Heavy Up to 1500 Newtons.	
Flexibility Grade	Excellent	
EN 50086 Definition	Flexible conduit.	

BMC - Type Brass Adaptors

Fixed Brass Fitting

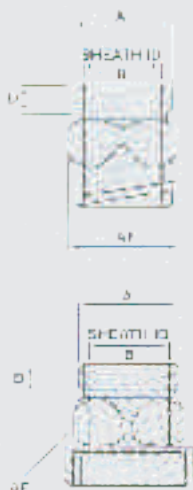

TYPE 1 SINGLE PIECE

THREAD	Single Piece Type 1		Two Piece Type 2			
	A	PART No.	PART No.	B	D	AF
METRIC	M12	BMC10M12	BMC10M12-2	7	8	15
	M16	BMC12M16	BMC12M16-2	10	8	15
	M20	BMC16M20	BMC16M20-2	13	10	23
	M20	BMC19M20	BMC19M20-2	15	10	23
	M20	BMC20M20	BMC20M20-2	17	10	23
PG	M25	BMC25M25	BMC25M25-2	21	10	31
	M32	BMC32M32	BMC32M32-2	28	12	40
	36	—	BMC40PG36-2	40	8	65
	48	—	BMC50PG48-2	52	10	65

Swivel Brass Fitting



TYPE 2 TWO PIECE

THREAD	Single Piece Type 1		Two Piece Type 2			
	A	PART No.	PART No.	B	D	AF
METRIC	M12	BMC10M12W	BMC10M12W-2	7	8	15
	M16	BMC12M16W	BMC12M16W-2	10	8	15
	M20	BMC16M20W	BMC16M20W-2	13	10	23
	M20	BMC19M20W	BMC19M20W-2	15	10	23
	M20	BMC20M20W	BMC20M20W-2	17	10	23
PG	M25	BMC25M25W	BMC25M25W-2	21	10	31
	M32	BMC32M32W	BMC32M32W-2	28	12	40
	36	—	BMC40PG36W-2	40	8	65
	48	—	BMC50PG48W-2	52	10	65

Brass 'S' - Type Adaptors



THREAD	A	PART NO..	B	C	D	AF
METRIC	M16	BMC112M16	10	35	10	20
	M16	BMC116M16	12	37	10	24
	M20	BMC116M20	12	37	10	24
	M20	BMC120M20	15.5	38	10	27
	M25	BMC125M25	20.5	38	10	33
	M32	BMC132M32	26.5	48	10	43
GAS	3/8"	BMC112G3/8	10	35	10	20
	3/8"	BMC116G3/8	12	37	10	20
	1/2"	BMC116G1/2	12	37	10	24
	1/2"	BMC120G1/2	15.5	38	10	27
	3/4"	BMC125G3/4	20.5	38	13	33
	1"	BMC132G1	26.5	48	14	43
	1 1/4"	BMC140G1 1/4	34.5	48	14	50
	1 1/2"	BMC150G1 1/2	39.5	57	16	60
	2"	BMC163G2	50.5	60	10	74
PG	9	BMC112PG9	10	35	10	20
	11	BMC112PG11	10	35	10	20
	13.5	BMC112PG13.5	10	35	10	20
	11	BMC116PG11	12	37	10	24
	13.5	BMC116PG13.5	12	37	10	24
	16	BMC116PG16	12	37	10	24
	13.5	BMC120PG13.5	15.5	38	10	27
	16	BMC120PG 16	15.5	38	10	27
	21	BMC125PG21	20.5	38	10	33
	29	BMC132PG29	26.5	48	13	43
	36	BMC140PG36	34.5	48	14	50
	42	BMC150PG42	39.5	57	14	60
	48	BMC1635PG48	50.5	60	16	74



THREAD	A	PART NO..	B	C	PART NO.B	C
METRIC	M12	BNL 12	19	7	BBL12	15
	M16	BNL 16	22	7.5	BBL16	19
	M20	BNL 20	27	7.5	BBL20	27
	M25	BNL 25	34	8.5	BBL25	30
	M32	BNL 32	41	8.5	BBL32	36
	M40	BNL 40	48	9.5	-----	--
GAS	M50	BNL 50	58	9.5	-----	--
	1/4"	BNL 1/4	--	7	BBL1/4	15
	3/8"	BNL 3/8	22	7.5	BBL3/8	19
	1/2"	BNL 1/2	30	7	BBL1/2	27
	3/4"	BNL 3/4	34	7	BBL3/4	30
	1"	BNL 1	40	8	BBL1	36
	1 1/4"	BNL1 1/4	50	10	BBL1 1/4	45
	1 1/2"	BNL 1/2	58	10	BBL1 1/2	52
	2"	BNL 2	70	8	BBL2	65
PG	7	BNL 7	19	7	BBL7	16
	9	BNL 9	22	7	BBL9	19
	11	BNL 11	27	7	BBL11	22
	13.5	BNL 13.5	28	7	BBL13.5	27
	16	BNL 16PG	30	7	BBL16PG	32
	21	BNL 21	34	8	BBL21	42
	29	BNL 29	44	8	BBL29	52
	36"	BNL 36	56	8	BBL36	60
	42"	-----	----	---	BBL42	65
	48"	-----	----	---	BBL48	74

D - Type Brass Adaptors

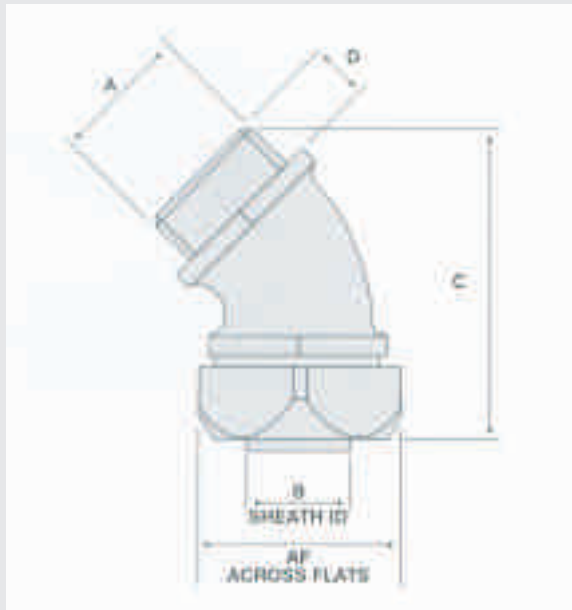

THREAD	A	PART NO..	B	C	D	AF
METRIC	M16	BMC112M16-45	10	51	10	22
	M16	BMC116M16-45	12	56	10	25
	M20	BMC116M20-45	12	56	10	25
	M20	BMC120M20-45	15.5	56	10	27
	M25	BMC125M25-45	20.5	62	10	33
	M32	BMC132M32-45	26.5	80	13	42
GAS	3/8"	BMC112G3/8-45	10	51	10	22
	3/8"	BMC116G3/8-45	12	56	10	25
	1/2"	BMC116G1/2-45	12	56	10	25
	1/2"	BMC120G1/2-45	15.5	56	10	27
	3/4"	BMC125G3/4-45	20.5	62	10	33
	1"	BMC132G1-45	26.5	80	13	42
	1 1/4"	BMC140G1 1/4-45	34.5	94	14	51
	1 1/2"	BMC150G1 1/2-45	39.5	110	15	60
	2"	BMC163G2-45	50.5	125	22	74
	PG	9	BMC112PG9-45	10	51	10
11		BMC112PG11-45	10	51	10	22
11		BMC116PG11-45	12	56	10	25
13.5		BMC120PG13.5-45	15.5	56	10	27
16		BMC120PG16-45	15.5	56	10	27
21		BMC125PG21-45	20.5	62	10	33
29		BMC132PG29-45	26.5	80	13	42
36		BMC140PG36-45	34.5	94	14	51
42		BMC150PG42-45	39.5	110	15	60
48		BMC163PG48-45	50.5	125	22	74

THREAD	A	PART NO..	B	C	D	AF
	M16	BMC112M16-90	10	42	10	22
	M16	BMC116M16-90	12	47	10	25
	M20	BMC116M20-90	12	47	10	25
	M20	BMC120M20-90	15.5	50	10	27
	M25	BMC125M25-90	20.5	57	10	33
	M32	BMC132M32-90	26.5	70	13	42
GAS	3/8"	BMC112G3/8-90	10	42	10	22
	3/8"	BMC116G3/8-90	12	47	10	25
	1/2"	BMC116G1/2-90	12	47	10	25
	1/2"	BMC120G1/2-90	15.5	47	10	27
	3/4"	BMC125G3/4-90	20.5	50	10	33
	1"	BMC132G1-90	26.5	57	13	42
	1 1/4"	BMC140G1 1/4-90	34.5	70	14	51
	1 1/2"	BMC150G1 1/2-90	39.5	85	15	60
2"	BMC163G2-90	50.5	98	22	74	
PG	9	BMC112PG9-90	10	117	10	22
	11	BMC112PG11-90	10	42	10	22
	11	BMC116PG11-90	12	42	10	25
	13.5	BMC120PG13.5-90	15.5	50	10	27
	16	BMC120PG16-90	15.5	50	10	27
	21	BMC125PG 21-90	20.5	57	10	33
	29	BMC132PG29-90	26.5	70	13	42
	36	BMC140PG36-90	34.5	85	14	51
	42	BMC150PG42-90	39.5	98	14	60
	48	BMC163PG48-90	50.5	117	22	74

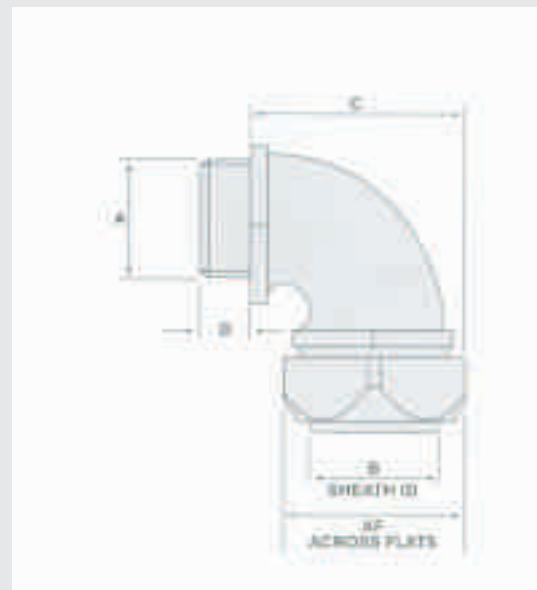

Conduits Accessories

Brass Accessories Male - Female Bushes



Material	Brass as per BS 2874
Finish	Brass as natural
Sizes	
Metric	20 mm to 50 mm (Short & Long patterns)
Imperial	3/4" to 2" (short & long patterns)

G. I. Accesories



G.I	-	Coupling
G.I	-	Junction Boxes
G.I	-	Lock Nut & Lock Ring
G.I	-	Saddle (Spacer Bar Saddle)
G.I	-	Crampet, Box Lid, Elbow, Tee, Doom Cover, Solid & Normal Band, Hook

Pre-Galvanised Switch And Socket Boxes



PART No.	SIZE
BPB 161	3" X 3" X 16 mm
BPB 251	3" x 3" x 25 mm
BPB 351	3" x 3" x 35 mm
BPB 471	3" x 3" x 47 mm
BPB 252	3" x 6" x 25 mm
BPB 352	3" x 6" x 35 mm
BPB 472	3" x 6" x 47 mm

Biax at a glance



Corporate Office : 278/5, Ashirwad Industrial Estate, Ram Mandir Road Goregaon (W) Mumbai - 400 104 INDIA
Tel : +91-22+28751930 **Fax :** +91-22-28768142 **Email :** mumbai@BiaxGroup.com
Branch Office : 301 Gupta Tower-II, G-33 AEZ Square, Vikaspuri, New Delhi - 110 018, INDIA
Tel : +91-11-25509195 **Fax :** +91-11-25509189 **Email :** delhi@BiaxGroup.com
Plant I : A-8, G.I.D.C. Industrial Estate Udyognagar, Jamnagar - 361 004, (Gujarat), INDIA
Tel : +91-288-2560387 **Fax :** 91-288-2561900 **Email :** jamnagar@BiaxGroup.com
Plant II : 286/1/2, Old Dena Bank Road, Silvassa, Dadra, Dadra & Nagar Haveli (U.T.) INDIA
Tel : +91-260+2669944 **Fax :** +91-260+2669977 **Email :** silvassa@BiaxGroup.com

www.BiaxGroup.com

[email : info@BiaxGroup.com](mailto:info@BiaxGroup.com)